

THIS DRAWING IS UNPUBLISHED. RELEASED FOR PUBLICATION, 19  
 © COPYRIGHT 1980 BY AMP INCORPORATED, HARRISBURG, PA. ALL INTERNATIONAL RIGHTS RESERVED. AMP PRODUCTS MAY BE COVERED BY U.S. AND FOREIGN PATENTS AND/OR PATENTS PENDING.

				1 LOC AF DIST 50	
REVISIONS					
P	F	ZONE	LTR	DATE	APPROVED
			T	9-17-85	JR
	✓		U	2-7-86	JR/GY
					REVISIONS
					REDRAWN
					REVISED AF-1746

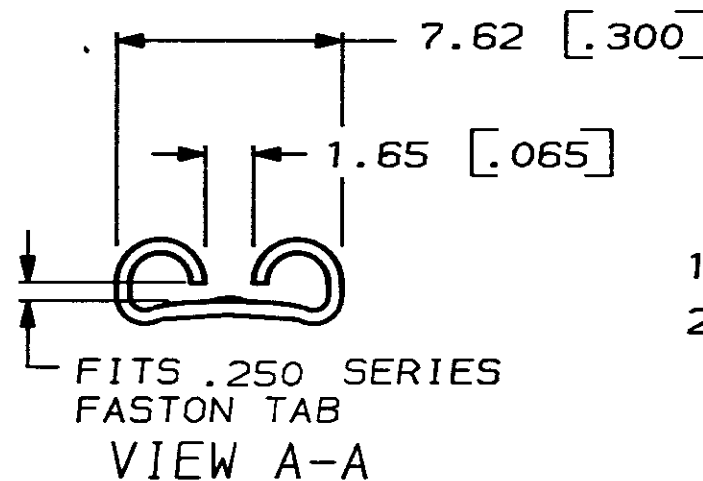

1- DIM'S IN BRACKETS ARE IN INCHES.  
 2- CONTINUOUS STRIP ON REELS.

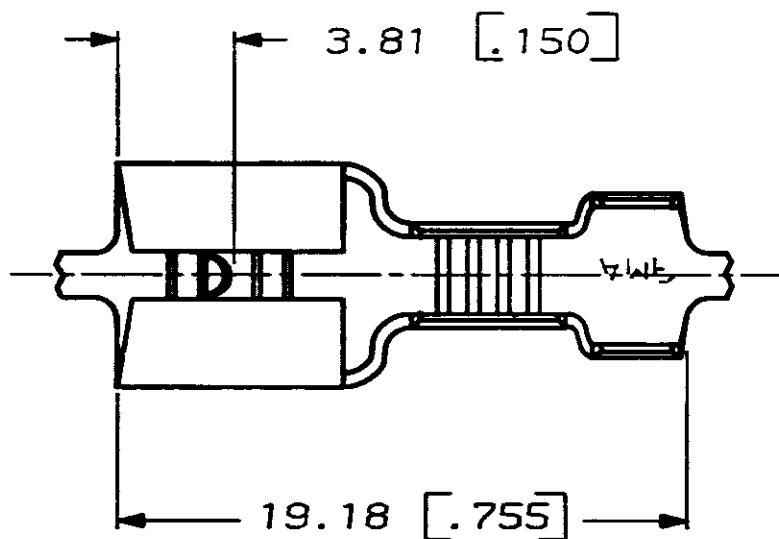
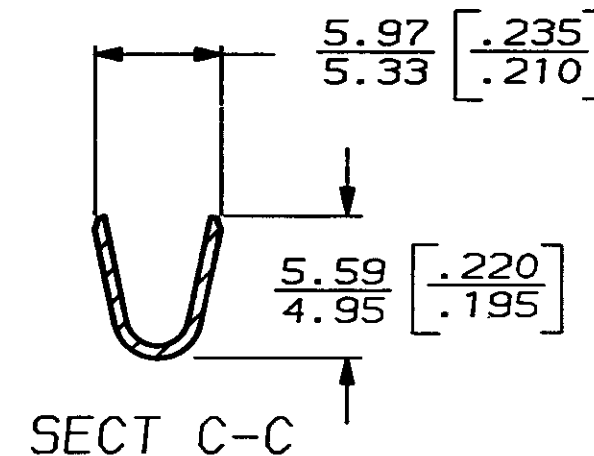
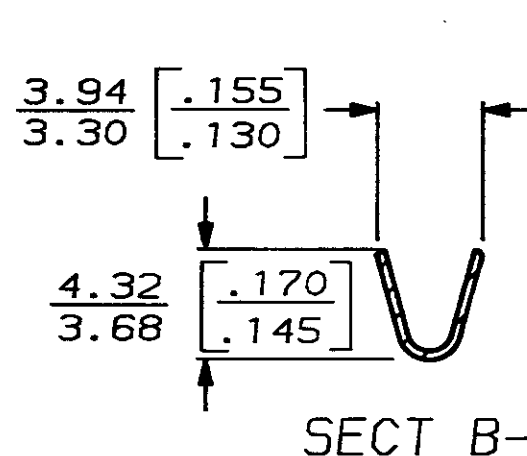
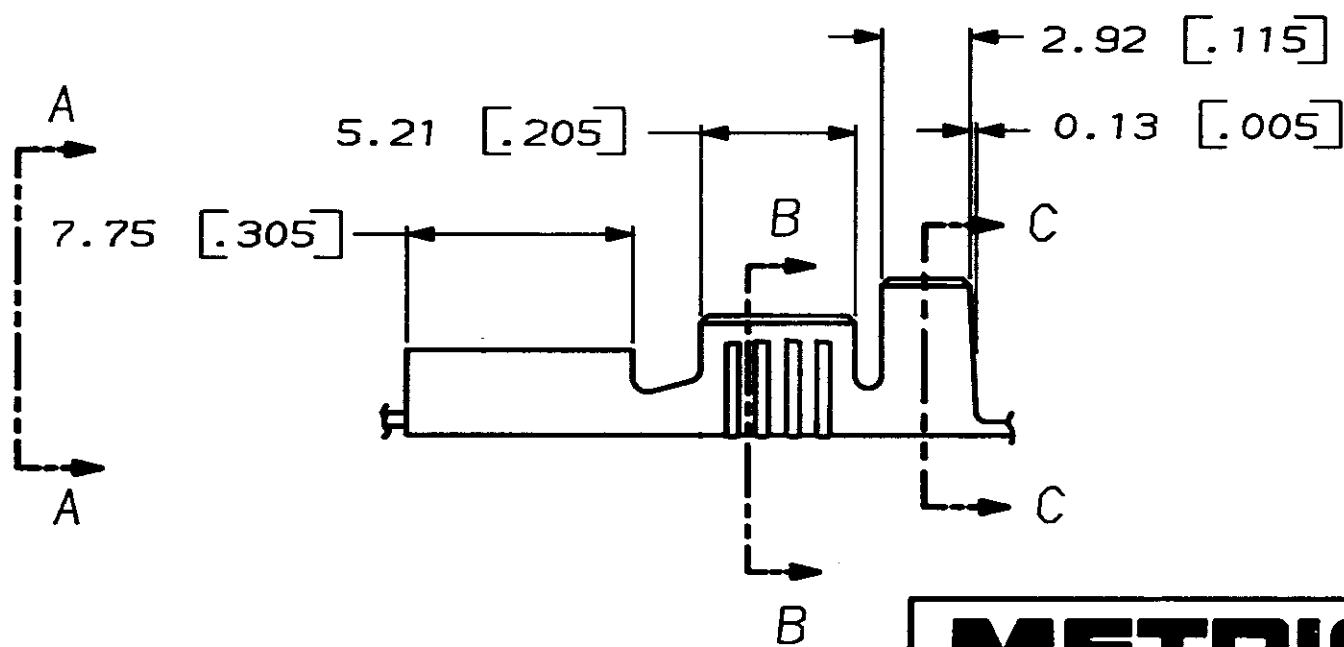

### METRIC

		3.05-4.32 [.120-.170]		0.8-2.0mm <sup>2</sup> [18-14]		0.81 ±0.025 [.032] ±.001		41202	
		INSUL RANGE		WIRE SIZE		TAB THK		PART NO	
0	4.57 [.180]	6.4 [.252]	F	3.05 [.120]	1.90 [.075] 2.0mm <sup>2</sup> [14]	UNLESS OTHERWISE SPECIFIED DIMENSIONS ARE IN MILLIMETERS. TOLERANCES ON DECIMALS ± 0.25 (0.01) ANGLES ±		CONTRACT NO	
					1.68 [.066] 1.3mm <sup>2</sup> [16]	DR JR RUTH 2-7-86		<b>AMP</b> AMP INCORPORATED Harrisburg, Pa.	
					1.55 [.061] 0.8mm <sup>2</sup> [18]	CHK G YETTER 2-7-86			
					±.051 [.002] HEIGHT	MATERIAL BRASS			
					0.46 [.018]	APPD C MEYERS 2-7-86		NAME .250 SERIES FASTON RECEPTACLE	
					FINISH	APPD R KUZO 2-7-86		DRAWING NO 41202	
						DSGN APPD		SIZE B	
						OTHER APPD		FSCM NO 00779	
								DRAWING NO 41202	
								SCALE NTS	
								SHEET 1 OF 1	